

South Carolina Pursuant to (407)

warrant from John Thomas Esq.
 Commissioner of locations N. Saluda
 dated 3rd June 1797. I have surveyed
 for George Deavers a tract of land
 lying in Spartanburg County bounds
 on the branches of Sholey Creek
 of Lawsons fork of Pacolat river
 Bounded N. by Winns land W.
 by Kellys land, Balenger
 Venable S. by Mitchums land
 E. by vacant land containing four
 hundred & one acres, and hath
 such marks, cutting & boundings
 as the annexed plat represents
 Surveyed 29th July 1797, by
 Jas. Smith Esq.

Recorded 20th Aug. 1797

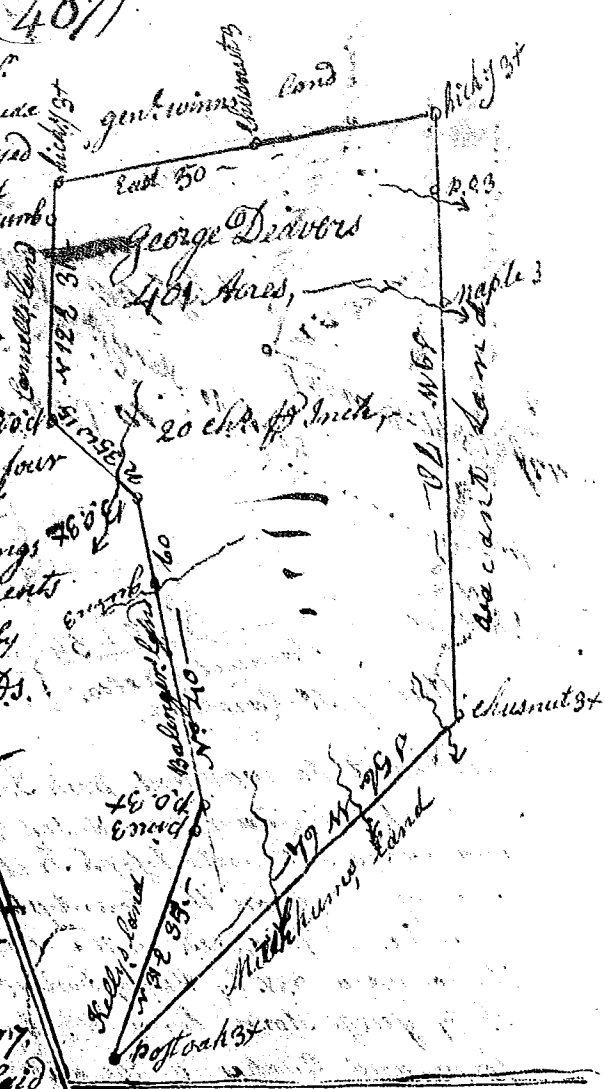

South Carolina,
 Pursuant to a warrant
 from John Thomas Esq. Com.
 of locⁿ N. side of Saluda
 river dated 19th Aug. 1797.
 I have admeasured and laid

out unto Benjamin Clark a tract
 of one hundred & seventy four
 acres in pinkney District and
 Spartanburg County on the south
 side of S. Pacolat river, Bounded
 by a line running S. E. by Samuel
 Spencer N. E. by land survey
 for Thomas Bennett, N. W. by
 land unknown the other side
 by vacant land, and hath
 such form and marks as the
 above plat represents,

Surveyed 21st Aug. 1797

Gal. Benson D.
 Recorded 4th Oct. 1797
 Del. W. Benson

